



## Water tractor tug 32 ton BP

### General

Yard no.	
Delivery date	
Basic functions	Towing, mooring and fire fighting operations
Classification	Indian Register of shipping

### Dimensions

Length o.a.	32,60 m
Beam o.a.	10.7 m
Depth at sides	4.00 m
Draught aft	4.65 m

### Tank capacities

Fuel oil	: min 50 .00m3
Fresh water	:15.00 m3
Lub.oil	:3.2 m3
Foam	:23.5 m3

### Performances (trials)

Bollard pull	: 32.00 ton(m)
Speed	:12.0 knots

### Propulsion System

Main engines	: 2 x Caterpillar or Cummins KTA38M or equ.
Total power	: 2600 kW at 900 rpm
Gearboxes	: 2 x Reintjes WAF 1561/4.85 :1 or equ.
Propulsion	:2 x Lips Zcontr.pitch 2500 mm in Nozzeles.
Rudder /sterngear	Streamlined airfoil/sperry

### Auxiliary equipment

Generator sets	: 2 x Perkins or equ.and harbour gen set
Capacity	: 2 x 120 kVA ,40kva
Sewage plant	.....
Bilge pump	50 m3/hr,2.6 atm
I.O.Purifier	.....
Fifi pump	Nijnhuis 600 m <sup>3</sup> /hr
Fifi monitors	Counterfire 2x600 m3/hr water or Foam
Bowthruster	

### Deck lay-out

Anchors	2x 270 kg Pool (High Holding Power)
Chain	166 m studlink, dia.17,5 mm U2 , electric
Anchor winch	Kraaijeveld,Electric
Capstan	hydraulic 5 ton pull
Deckcrane	Effer 12000-25, 1.25 ton at 8.6 m
Towing hook	40 tonf sWL
Towing winch	10/5 ton pull at 10 /20 m/min

### Accommodation

16 Persons

### Nautical and communication equipment

Nautical and communication equipment GMDss area A1	
Radar	: Furuno FR-8051
GPs	: Furuno GP-80
Echosounder	Furuno FE-606
Navtex	: Furuno NX-500
VHF radio	2x Sailor RT2048 with DsC RM2042
SSB radio telephone	Furuno FS-1562-25 with DSC-6A

### Operating Area

Red sea Egypt

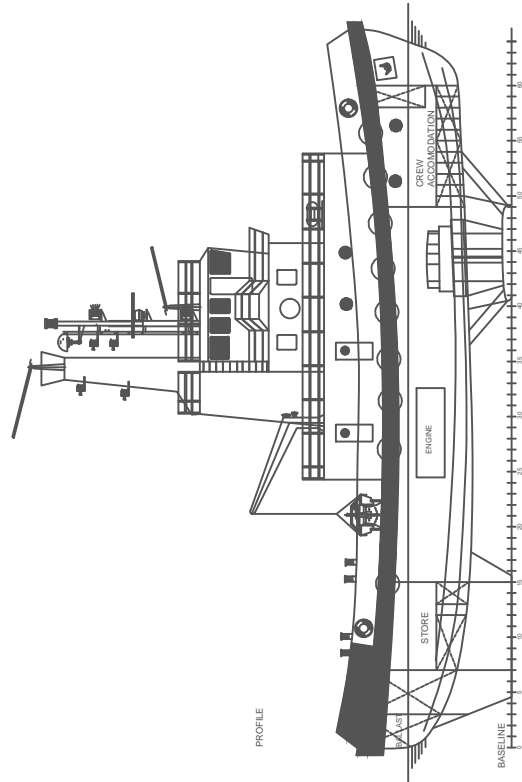

PROFILE

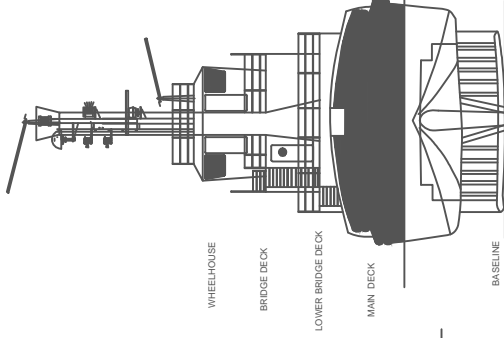

WHEELHOUSE

BRIDGE DECK

LOWER BRIDGE DECK

MAIN DECK

BASELINE

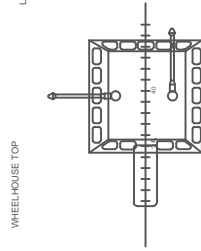

WHEELHOUSE TOP

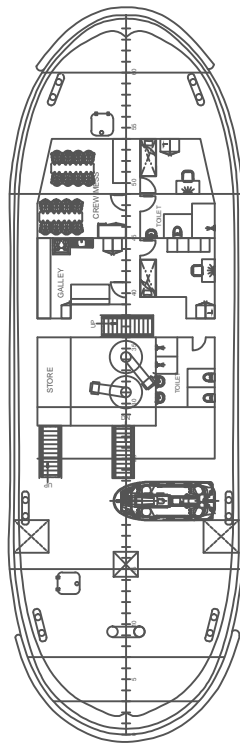

MAIN DECK

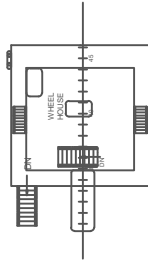

BRIDGE DECK

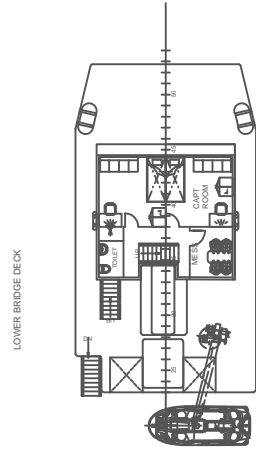

LOWER BRIDGE DECK

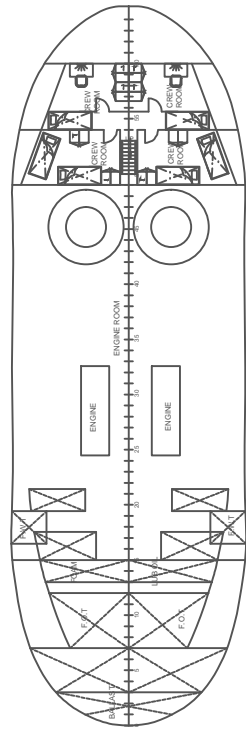

PRINCIPAL DIMENSIONS  
 LENGTH O.A. 32.60 m  
 BEAM 10.70 m  
 DEPTH AT SIDES 4.00m  
 DRAUGHT AFT 4.65m

REVISION	DESCRIPTION
C	
B	
A	



Jacobi Spijker direct 186  
 2132 FZ Hoofddorp  
 The Netherlands  
 Tel. +31(0)25-3547310

WATER-TRACTOR-TUG

Title:	GENERAL-ARRANGEMENT		
Scale:	Drawn:	Size:	Date:
1:20	AMVA/MGDP	A3	21-5-2014
		REV:	YARD No:
			AAM201405-000
			PROJ.No: AAM201405

This drawing is provided by copyright and property of the designers so that alterations may be approved or modified or used for any manner without permission.